

GEFZ...T

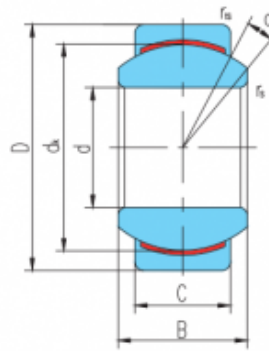
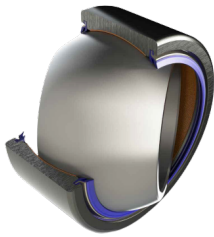

select	Inquiry	Bearing number	Overall dimension [mm]								Rated load [kN]		Weight kg
			d	D	B	C	d _k	r _s min	r _{is} min	a°	live load	Static load	
GEFZ4T	4.83	14.29	7.14	5.54	10.31	3	0.38	11	7.4	11	0.006		
GEFZ4T	0.19	0.5625	0.281	0.218	0.406	0.012	0.015	11	7.4	11	0.006		
GEFZ6T	6.35	16.67	8.71	6.35	12.7	0.3	0.56	13.5	10	15	0.010		
GEFZ6T	0.25	0.6562	0.343	0.25	0.5	0.012	0.022	13.5	10	15	0.010		
GEFZ7T	7.94	19.05	9.53	7.14	14.27	0.3	0.81	12	13	19	0.014		
GEFZ7T	0.3125	0.75	0.375	0.281	0.562	0.012	0.032	12	13	19	0.014		
GEFZ9T	9.53	20.64	10.31	7.92	16.66	0.3	0.81	10	17	25	0.018		
GEFZ9T	0.375	0.8125	0.406	0.312	0.656	0.012	0.032	10	17	25	0.018		
GEFZ11T	11.11	23.02	11.1	8.71	17.45	0.3	0.81	8	19	28	0.021		
GEFZ11T	0.4375	0.9062	0.437	0.343	0.687	0.012	0.032	8	19	28	0.021		
GEFZ12T	12.7	25.4	12.7	9.91	20.65	0.3	0.81	9.5	26	39	0.029		
GEFZ12T	0.5	1	0.5	0.39	0.813	0.012	0.032	9.5	26	39	0.029		
GEFZ14T	14.29	27.78	14.27	11.1	23.01	0.3	0.81	9.5	33	49	0.042		
GEFZ14T	0.5625	1.0937	0.562	0.437	0.906	0.012	0.032	9.5	33	49	0.042		
GEFZ15T	15.88	30.16	15.88	12.7	25.4	0.3	0.81	9.5	41	61	0.053		
GEFZ15T	0.625	1.1875	0.625	0.5	1	0.012	0.032	9.5	41	61	0.053		
GEFZ19T	19.05	36.51	19.05	15.06	30.15	0.3	1.12	9	59	88	0.094		
GEFZ19T	0.75	1.4375	0.75	0.593	1.187	0.012	0.044	9	59	88	0.094		
GEFZ22T	22.23	39.69	22.23	17.86	33.32	0.6	1.12	9.5	89	133	0.119		
GEFZ22T	0.875	1.5625	0.875	0.703	1.312	0.024	0.044	9.5	89	133	0.119		
GEFZ25T	25.4	44.45	25.4	20.24	38.1	0.6	1.12	10	115	172	0.173		
GEFZ25T	1	1.75	1	0.797	1.5	0.024	0.044	10	115	172	0.173		