

GEFZ..C

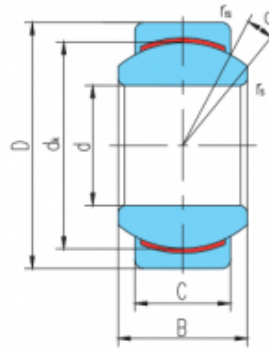
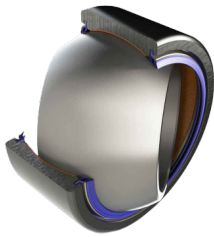

select	Inquiry	Bearing number	Overall dimension [mm]								Rated load [kN]		Weight kg
			d	D	B	C	d _k	r _s min	r _{1s} min	a°	live load	Static load	
GEFZ4C	4.83	14.29	7.14	5.54	10.31	0.3	38	11	5.1	12.8	0.006		
GEFZ4C	0.19	0.5625	0.281	0.218	0.406	0.012	0.015	11	5.1	12.8	0.006		
GEFZ6C	6.35	16.67	8.71	6.35	12.7	0.3	0.56	13.5	7.2	18.4	0.010		
GEFZ6C	0.25	0.6562	0.343	0.25	0.5	0.012	0.022	13.5	7.2	18.4	0.010		
GEFZ7C	7.94	19.05	9.53	7.14	14.27	0.3	0.81	12	9.1	22.9	0.014		
GEFZ7C	0.3125	0.75	0.375	0.281	0.562	0.012	0.032	12	9.1	22.9	0.014		
GEFZ9C	9.53	20.64	10.31	7.92	16.66	0.3	0.81	10	11.8	29.6	0.018		
GEFZ9C	0.375	0.8125	0.406	0.312	0.656	0.012	0.032	10	11.8	29.6	0.018		
GEFZ11C	11.11	23.02	11.1	8.71	17.45	0.3	0.81	8	13.6	34.1	0.021		
GEFZ11C	0.4375	0.9062	0.437	0.343	0.687	0.012	0.032	8	13.6	34.1	0.021		
GEFZ12C	12.7	25.4	12.7	9.91	20.65	0.3	0.81	9.5	18.4	46	0.029		
GEFZ12C	0.5	1	0.5	0.39	0.813	0.012	0.032	9.5	18.4	46	0.029		
GEFZ14C	14.29	27.78	14.27	11.1	23.01	0.3	0.81	9.5	23	57.4	0.042		
GEFZ14C	0.5625	1.0937	0.562	0.437	0.906	0.012	0.032	9.5	23	57.4	0.042		
GEFZ15C	15.88	30.16	15.88	12.7	25.4	0.3	0.81	9.5	29	72.5	0.053		
GEFZ15C	0.625	1.1875	0.625	0.5	1	0.012	0.032	9.5	29	72.5	0.053		
GEFZ19C	19.05	36.51	19.05	15.06	30.15	0.3	1.12	9	40.8	102.1	0.094		
GEFZ19C	0.75	1.4375	0.75	0.593	1.187	0.012	0.044	9	40.8	102.1	0.094		
GEFZ22C	22.23	39.69	22.23	17.86	33.32	0.6	1.12	9.5	53.5	133.8	0.119		
GEFZ22C	0.875	1.5625	0.875	0.703	1.312	0.024	0.044	9.5	53.5	133.8	0.119		
GEFZ25C	25.4	44.45	25.4	20.24	38.1	0.6	1.12	10	69.4	173.5	0.173		
GEFZ25C	1	1.75	1	0.797	1.5	0.024	0.044	10	69.4	173.5	0.173		