

## 63000 Series

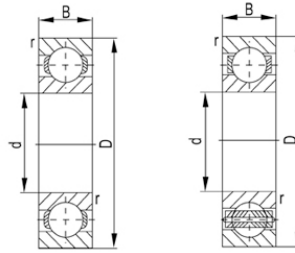

**select Inquiry Bearing No.    Boundary dimensions [mm]    Basic load ratings(kN)    Mass**

			<b>d</b>	<b>D</b>	<b>B</b>	<b>rs min</b>	<b>Dynamic(Cr)</b>	<b>Static(Cor)</b>	<b>Kg</b>
63001	12	28	12	-	-	-	-	-	-
63002	15	32	13	-	-	-	-	-	-
63003	17	35	14	-	-	-	-	-	-
63004	20	42	16	-	-	-	-	-	-
63005	25	47	16	-	-	-	-	-	-
63006	30	55	19	-	-	-	-	-	-
63007	35	62	20	-	-	-	-	-	-
63008	40	68	21	-	-	-	-	-	-
63009	45	75	23	-	-	-	-	-	-
63010	50	80	23	-	-	-	-	-	-